

Embroidered Patchwork Coaster –Tutorial

CRAFTING THE EMBROIDERED PATCHWORK COASTER: A VISUAL TUTORIAL (USING AMERICAN QUILTING & SEWING METHODS)

1 PREPARATION & MATERIALS



KEY METHODS USED

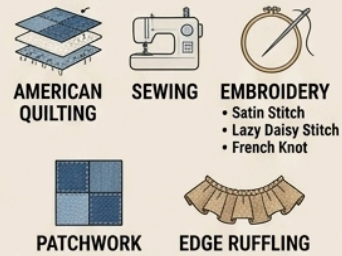

2 STEP 1: EMBROIDERY

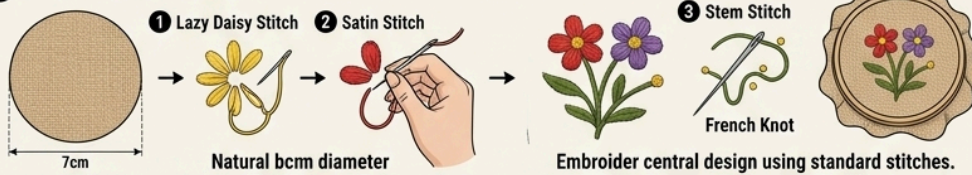

3 STEP 2: CUTTING & PIECING DENIM

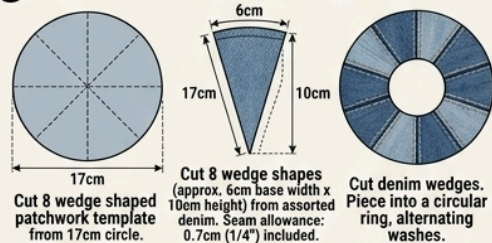

4 STEP 3: ASSEMBLE TOP & APPLY LACE

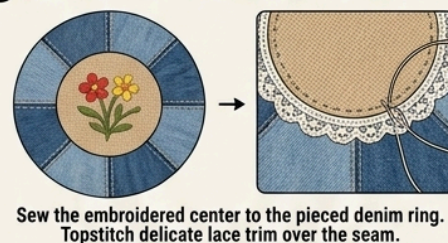

5 STEP 4: PREPARE AND APPLY RUFFLE

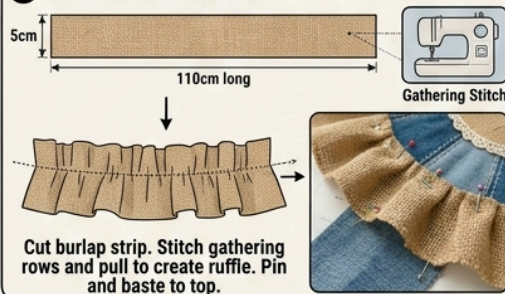

6 STEP 5: SANDWICHING & FINAL STITCHING

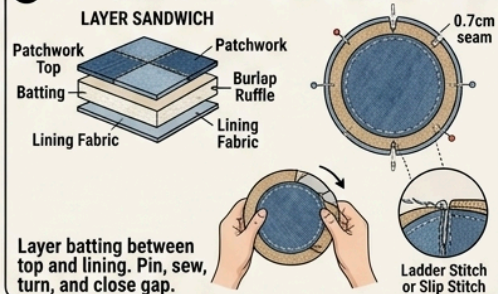

7 STEP 6: HAND QUILTING (OPTIONAL)

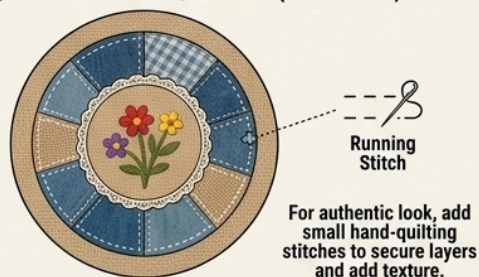

This tutorial will guide you through the complete process of creating a beautiful **embroidered patchwork coaster** using classic **American quilting, sewing, and embroidery techniques**. The design combines embroidered burlap, denim patchwork, lace trim, and a decorative ruffled edge.

By following each step carefully, even beginners can successfully complete this project from start to finish.

Finished coaster size: **approximately 17 cm (6.7 inches) in diameter**

Preparation and Materials

Before starting, gather all your materials and tools. Preparing everything in advance makes the sewing process much easier.

Fabrics

You will need several different fabrics to build the coaster layers.

Denim Fabric Scraps

Use assorted denim pieces from old jeans or leftover fabric. Different washes create a beautiful patchwork effect.

Burlap Fabric (Natural Jute)

This fabric will be used for the embroidered center and the ruffled edge.

Lining Fabric

A soft cotton lining works best. Cotton muslin is a good option.

Lightweight Batting

Approximately **3 mm thick** batting will give the coaster softness and structure.

Additional Materials

- Embroidery thread (multiple colors for flowers and leaves)
- Embroidery hoop
- Hand sewing needles
- White sewing thread
- Lace trim
- Disappearing fabric pen
- Ruler
- Rotary cutter and cutting mat
- Sewing machine
- Iron

Having an **embroidery hoop** is especially helpful because it keeps the fabric tight while stitching.

Step 1: Embroider the Center Design

The embroidered center is the decorative highlight of the coaster.

Prepare the Fabric Circle

Cut a **burlap circle approximately 7 cm (2.75 inches) in diameter**.

Place the fabric inside your **embroidery hoop** to keep it stretched and stable while stitching.

Draw the Design

Using a **disappearing fabric pen**, lightly sketch a small floral design in the center of the circle. The example design includes:

- A small flower cluster
- Leaves and stems

Keep the design simple so it fits nicely inside the circle.

Stitch the Flowers

Use several basic embroidery stitches.

Lazy Daisy Stitch

This stitch creates flower petals.

Steps:

1. Bring the needle up through the fabric.
2. Insert it back close to the starting point to form a loop.
3. Bring the needle up at the tip of the loop.
4. Secure the loop with a small stitch.

Repeat this process to form multiple petals.

Satin Stitch

Use satin stitch to fill petals or flower centers.

Steps:

1. Bring the needle up on one side of the shape.
2. Insert it on the opposite side.
3. Continue making parallel stitches until the shape is fully filled.

Stitch the Stems

Use **Stem Stitch** for the flower stems.

Steps:

1. Bring the needle up at the beginning of the line.
2. Insert it slightly ahead along the line.
3. Bring the needle up halfway back toward the previous stitch.

This creates a twisted rope-like line that looks natural for plant stems.

Add Decorative Centers

Use **French Knots** for flower centers.

Steps:

1. Bring the needle up through the fabric.
2. Wrap the thread around the needle 2–3 times.
3. Insert the needle close to the original hole.
4. Pull slowly until the knot forms.

Once finished, remove the fabric from the hoop and lightly press it with an iron.

Step 2: Cut and Piece the Denim Patchwork

Now you will create the circular denim patchwork surrounding the embroidered center.

Cut the Base Circle

Cut a **17 cm (6.7 inch) circle** from denim or use it as your layout guide.

Divide this circle into **8 equal wedge sections**.

Cut the Wedges

Each wedge should measure approximately:

- **6 cm base width**
- **10 cm height**
- **0.7 cm (¼ inch) seam allowance included**

Cut **8 wedges** from assorted denim fabrics.

Using different denim shades will give the coaster a beautiful patchwork look.

Sew the Wedges Together

1. Place two wedges **right sides together**.
2. Sew along one long edge using a **0.7 cm seam allowance**.
3. Press the seam open.

Continue adding wedges one by one until all **8 pieces form a ring**.

When finished, press all seams flat.

Step 3: Assemble the Top and Attach Lace

Now the embroidered center and denim ring will be joined.

Attach the Center Circle

1. Place the embroidered burlap circle in the middle of the denim ring.
2. Pin carefully to keep it centered.
3. Sew around the circle edge.

This joins the embroidery piece to the denim patchwork.

Add Lace Trim

To soften the seam line, attach **lace trim** over the seam.

Steps:

1. Position the lace over the seam where burlap meets denim.
2. Pin it evenly around the circle.
3. Topstitch carefully to secure it.

This creates a delicate decorative detail.

Step 4: Prepare and Attach the Ruffled Edge

The ruffled burlap edge gives the coaster its vintage handmade appearance.

Cut the Ruffle Strip

Cut a strip of burlap measuring:

5 cm wide × 110 cm long

Create Gathering Stitches

Using your sewing machine:

1. Sew **two long gathering stitches** along the strip.
2. Do not backstitch.

Gather the Fabric

Pull the bobbin threads gently to gather the strip.

Continue gathering until the strip fits around the coaster edge.

Attach the Ruffle

1. Pin the ruffle around the outer edge of the patchwork top.
2. Distribute the gathers evenly.
3. Baste the ruffle in place with a temporary stitch.

Step 5: Sandwich the Layers and Final Stitching

Now the coaster layers are assembled.

Layer the Fabric

Create the following **layer sandwich**:

Top to bottom order:

1. Patchwork top with ruffle
2. Batting
3. Lining fabric

Align all layers carefully.

Pin the Layers

Place pins evenly around the edge to prevent shifting.

Sew Around the Edge

1. Sew around the coaster with a **0.7 cm seam allowance**.
2. Leave a small **opening** so the coaster can be turned.

Turn the Coaster

Carefully turn the piece right side out through the opening.

Use a blunt tool or chopstick to gently push out the edges.

Close the Opening

Close the opening using:

- **Ladder stitch**, or
- **Slip stitch**

Both stitches create nearly invisible seams.

Press the coaster lightly with an iron.

Step 6: Optional Hand Quilting

For an authentic quilted look, add decorative quilting stitches.

Use **running stitch** to quilt through all layers.

Stitch small evenly spaced stitches around the patchwork segments or near the center embroidery.

This step:

- Secures the layers
- Adds texture
- Enhances the handmade look

Your Embroidered Patchwork Coaster Is Finished 🎉

You now have a beautiful **handcrafted embroidered patchwork coaster** featuring:

- Hand embroidery
- Denim patchwork
- Decorative lace
- Burlap ruffle
- Soft quilted layers

Each coaster will look slightly different depending on the denim fabrics and embroidery colors you choose.

These coasters make wonderful:

- Handmade gifts
- Table decorations
- Craft fair items
- Kitchen accessories